

Marching Band Interactive  
67839

Play & Park Structures

This play equipment is recommended for children ages:  
2-5 or 5-12

Minimum Area Required:  
14'-2" x 6'-9"

Scale: 1/2" = 1'-0"  
This drawing can be scaled only when in an 11" x 17" format

Drawn By:

Date:  
1/13/2020

Quote Number:  
67839

play&park  
structures

A PLAYCORE Company

544 Chestnut Street  
Chattanooga, TN 37402  
800-727-1907 / www.playandpark.com

User Capacity

15

Critical Fall Height

N/A

ISO  
9001  
CERTIFIED

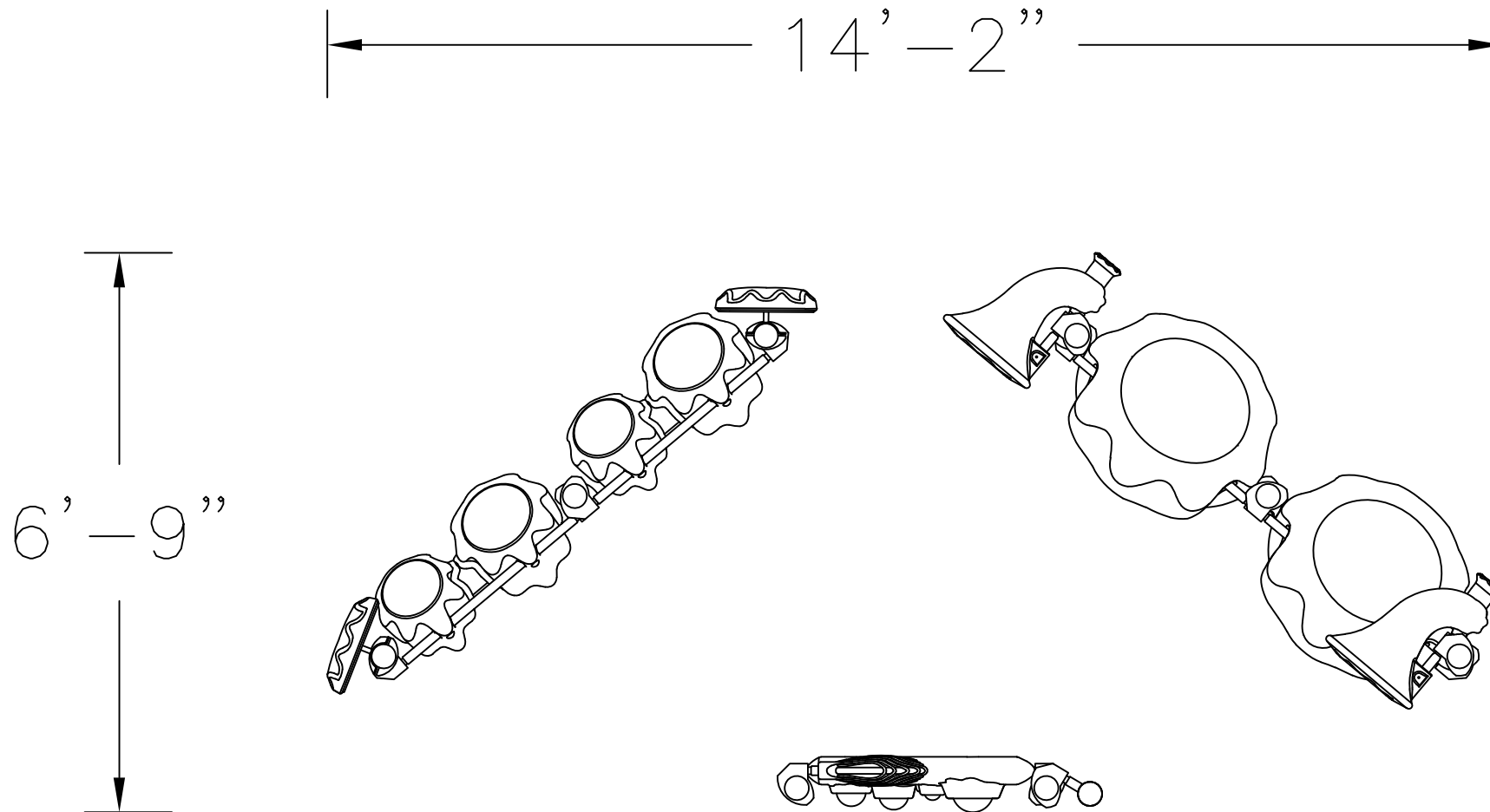

MARCHING BAND  
(INTERACTIVE)  
67839